

Linwave DC1276H-T Gunn Diode 26-40GHz

LW36-600005

DESCRIPTION

Gallium Arsenide graded gap Gunn diode assembled in custom package for fundamental mode of operation in the 26 to 40 GHz band.

Top cap is positive polarity.



Outline 106

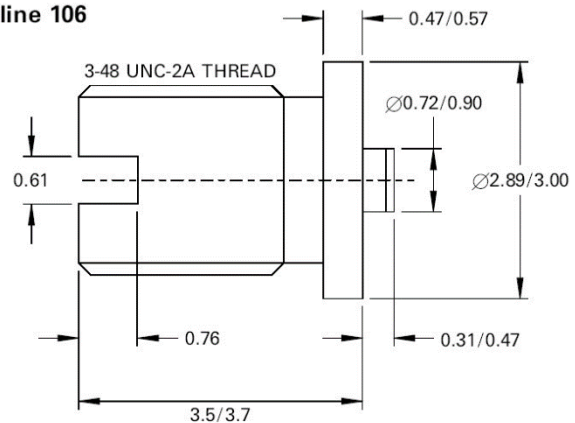

NOTES

1. The typical performance parameters indicated in the table overleaf can be customised to the user's requirements. The table shows typical values that can be achieved in a standard test cavity. Other variations may be possible using a customer specific test cavity.
2. Threshold current is defined as the maximum forward current in the DC current/ voltage characteristics.
3. A spot test frequency +/- 10% must be specified on the purchase order between the upper and lower limits which Linwave can test between.
4. Operating voltage is typically 6 V at 26 GHz and 4.5 V at 40 GHz though the devices will be tested at the optimum value.
5. Linwave Technology would prefer to test the gunn diode in the customer's own oscillator test cavity wherever practicable, to ensure it meets their operational requirements.

Linwave reserves the right to make changes, without notice, in the products, including circuits, standard cells, and/or software, described or contained herein in order to improve design and/or performance.

Data sheet Iss 02, dated 16/08/19 DS00-600005-02, No. 4260

For price, delivery and to place orders please contact
 Linwave Technology Ltd, Marlin Building, Sadler Road, Lincoln, LN6 3RS
 Company Reg No 4478971 (England)
 Phone:+44 (0) 1522 681811 Fax:+44 (0) 1522 681911
 Email enquiries@linwave.co.uk Website www.linwave.co.uk
 © 2016 Linwave Technology

Typical Electrical Specification (All tests shall be made at $T_{amb} = 23^{\circ}\text{C} \pm 5^{\circ}\text{C}$)

			Min (Typical)	Max (Typical)	
Operating Current	At Operating Voltage	I_{OP}		950	mA
Output Power		P_{OUT}	200		mW
Operating Frequency	See Note 3	F_{OP}	26	40	GHz
Threshold Current	See Note 2	I_{th}		1150	mA
Operating Voltage	See Note 4				
Start-Up Voltage		V_{ST}		4.0	V

Linwave reserves the right to make changes, without notice, in the products, including circuits, standard cells, and/or software, described or contained herein in order to improve design and/or performance.

Data sheet Iss 02, dated 16/08/19 DS00-600005-02, No. 4260

*For price, delivery and to place orders please contact
 Linwave Technology Ltd, Marlin Building, Sadler Road, Lincoln, LN6 3RS
 Company Reg No 4478971 (England)
 Phone:+44 (0) 1522 681811 Fax:+44 (0) 1522 681911
 Email enquiries@linwave.co.uk Website www.linwave.co.uk
 © 2016 Linwave Technology*